

EQP. NO.	EQUIPMENT
S1146	PROCESS AIR FILTER
N1153	BLOW-OFF SILENCER
C1361/C1461	AIR COMPRESSOR
C1361/C1461	FEED GAS/RECYCLE COMPRESSOR
D2431	WATER SEPARATOR
K2476	CHILLER UNIT
X3228A/B	ADSORBER
E2619	ELECTRICAL GENERATION GAS HEATER
N2653	BLOW-OFF SILENCER
X3471/2	EXPANSION TURBINE WITH BOOSTER
E3421/2	BOOSTER AFTERCOOLER
J3958	EJECTOR
N3953	BLOW OFF SILENCER
D7314/B/C	LIX TANK 3500M3
Y7194	LIX TRUCK FILLING STATION
D7310	LIN TANK 3500M3
E7319	LIN EVAPORATOR AIR HEATED
D7332	LIN SEAL GAS TANK 22.7m3
Y7394A/B	LIN TRUCK FILLING STATION
F7367A-C	LIN TRUCK FILLING PUMP
E8421A-C	COOLING TOWER

TAKE OVER POINTS

----- SAFETY DISTANCE ACC: EIGA 127/4  
(NO PITS, DUCTS, SURFACE WATER DRAINS, OPENINGS, SYSTEMS BELOW GROUND LEVEL)

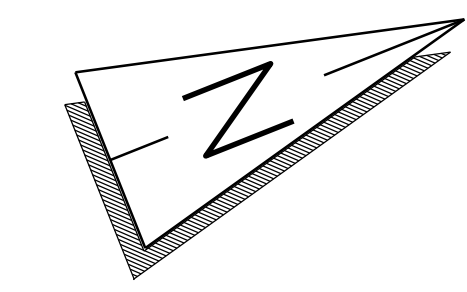

GEOGRAPHICAL NORTH

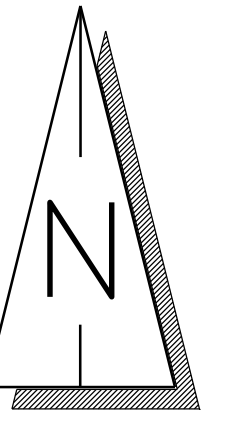

PLANT NORTH

CALCULATION OF AREAS:

PLANT AREA:	19.998 M2
ROADS AND PAVEMENTS:	10.626 M2
BUILDINGS AND FOUNDATIONS:	1.551 M2
GREEN AREA:	5.121 M2
GRAVEL AREA:	2.700 M2
FENCE:	486 M

Linde AG - Gas and Engineering - Linde Gas Division

## BASIC - DRAWING

**PROJECT:**  
AIR SEPARATION PLANT JUTLAND - DENMARK

**LINOX 4/15  
KONGENS KVARTER**

**LAYOUT** SCALE 1: 250

**PROMOTER:**

**ENGINEERING:**  
Linde AG  
Linde Gas Division  
Dep.: G&P ENGINEERING CIVIL Phone: + 49 89 7446 - 1719  
Seitnerstrasse 70  
D - 82048 Puchheim / Germany

NO.	REVISION	DATE	CHECKED	DATE	RELEASED	DATE
0	DRAWN	DATE	CHECKED	DATE	RELEASED	DATE

THIS DOCUMENT MUST BE TREATED AS CONFIDENTIAL.  
IT MAY NOT BE COPIED, DISTRIBUTED TO OTHERS,  
OR ITS CONTENTS BE USED OR COMMUNICATED,  
EITHER IN WHOLE OR IN PART, WITHOUT WRITTEN  
PERMISSION. ALL RIGHTS ARE RESERVED.

DEP.: G&P CIVIL **P17.C.007.500.010.0**

3D-CAD-DRAWING PAGE OF

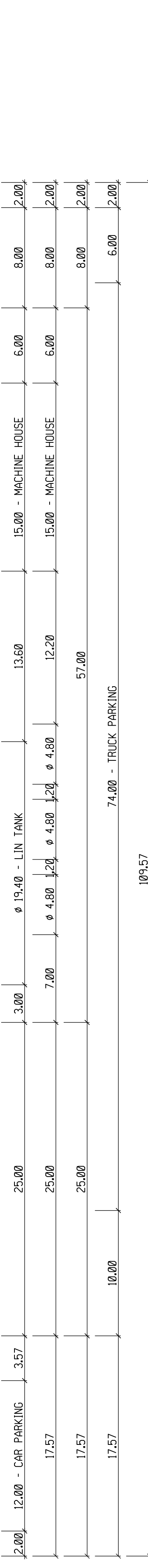
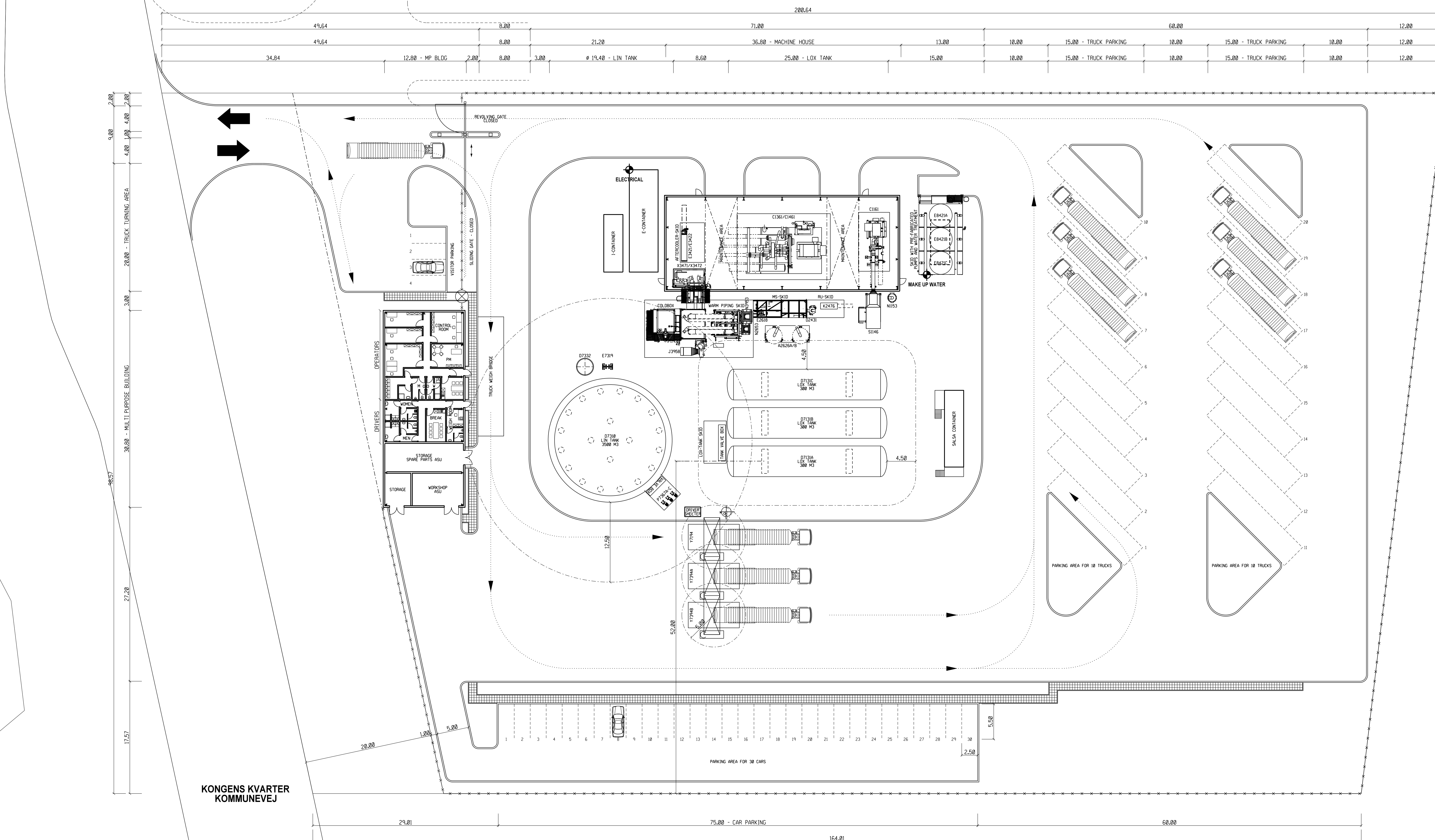

KONGENS KVARTER  
KOMMUNEVEJ

